

TR1M Eastbound

NOTES:

1. This drawing has been produced based on the latest MX highway model – Draft Design Freeze 7, as provided by the client.
2. This drawing has been produced mainly for the purpose of planning application.
3. Only one option has been considered for this location as per client's instructions.
4. Levels are in meters and above Ordnate Datum.
5. All dimension are in millimeters.
6. The option shown on this drawing is based on the latest available geotechnical information.
7. Basic preliminary design has been undertaken to determine the geometry of the section sizes as per client's instruction.

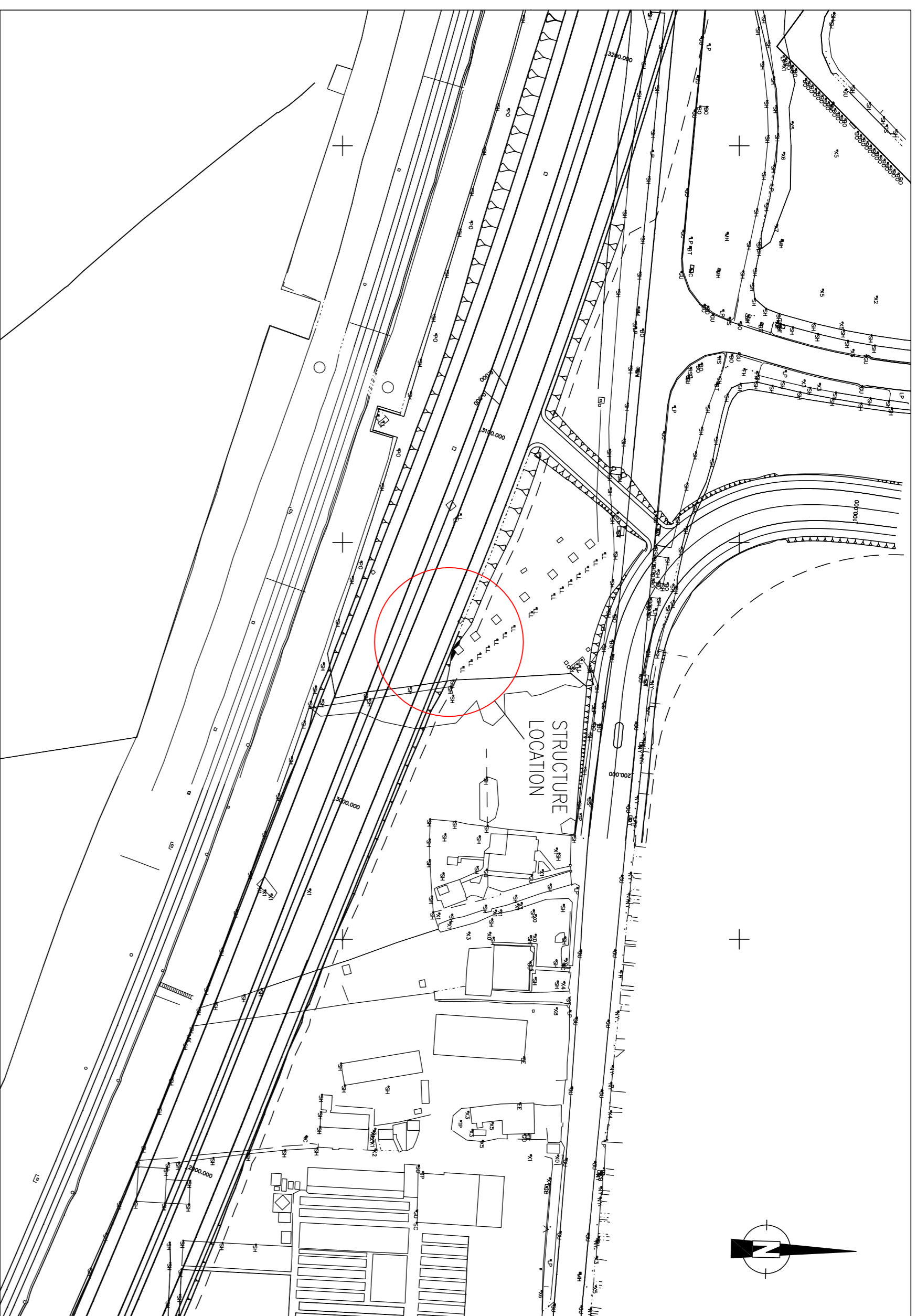

LOCATION PLAN
SCALE 1:1000

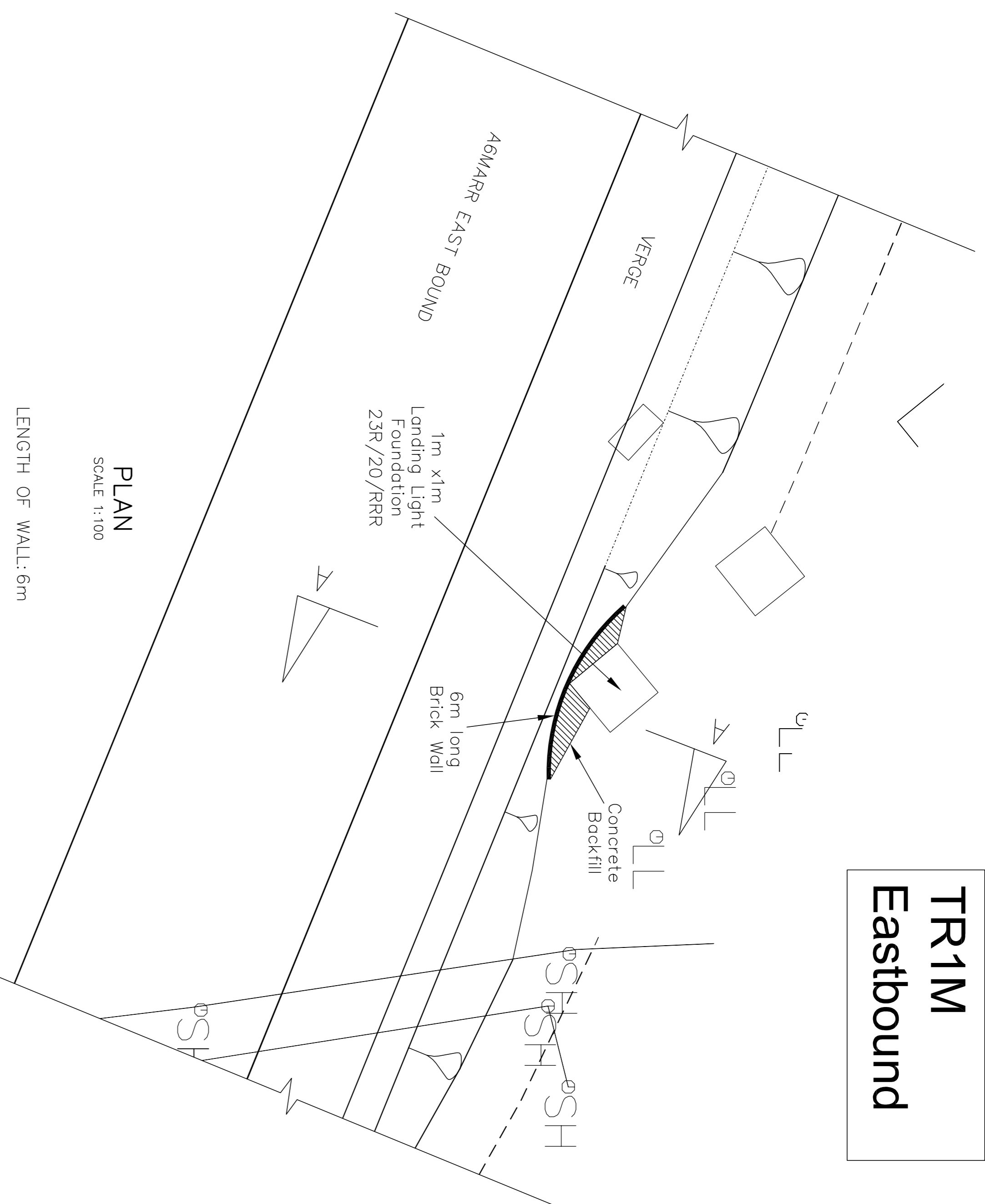

PLAN
SCALE 1:100

LENGTH OF WALL: 6m

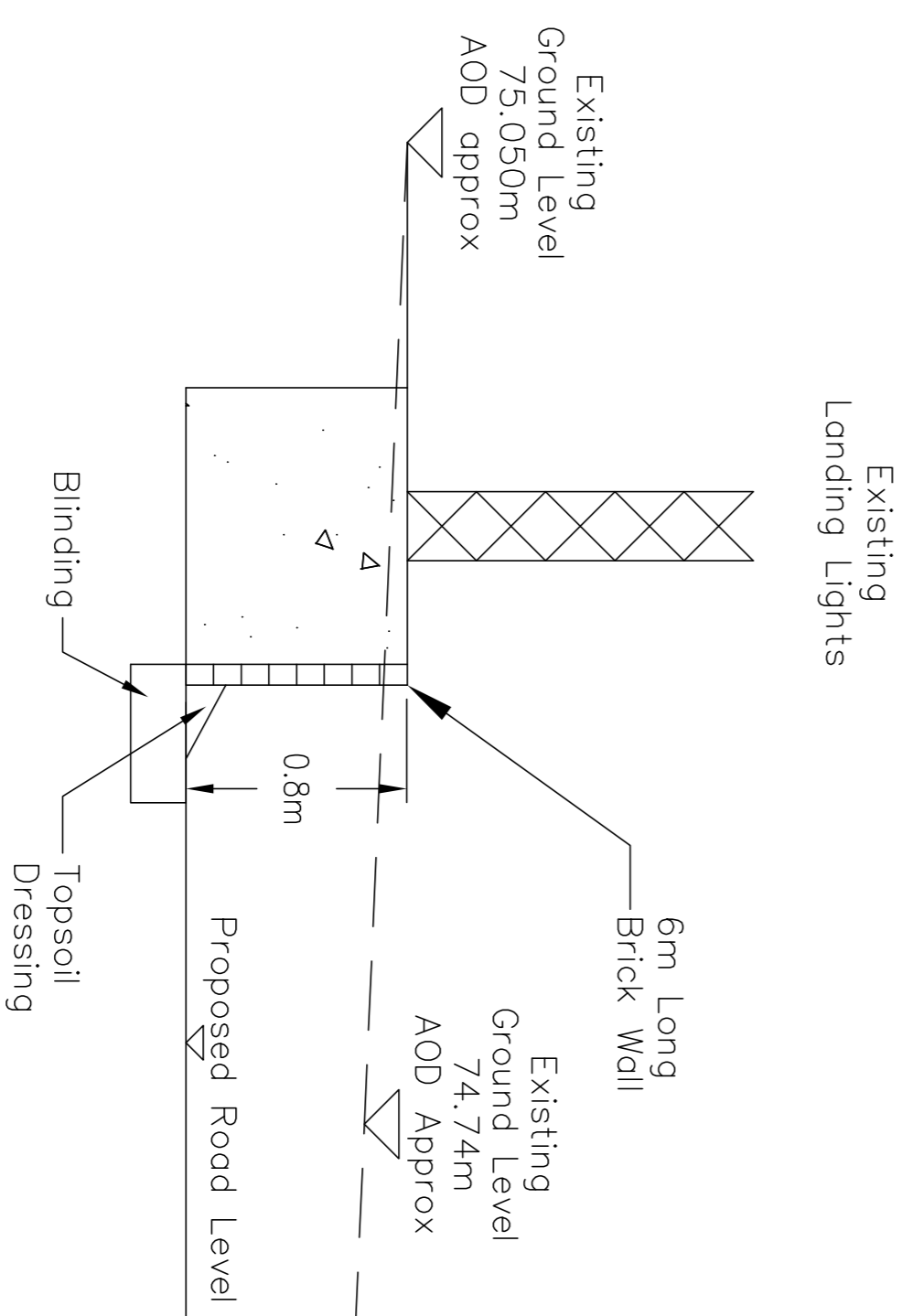

SECTION A-A
SCALE 1:25

Drawing Title

RETAINING WALL TR1M
GENERAL ARRANGEMENT

Rev.	Drawn	Checked	Date	Revision Details
A	DB	ME	13/09/13	Issued for Planning
-	DB	ME	30/08/13	First Issue



Jim Malison BSc, CEng, MICE
STOCKPORT HOUSE
STOCKPORT, CHESHIRE, SK1 1HS

Job Title

A6 TO MANCHESTER AIRPORT
RELIEF ROAD

Drawing Title

RETAINING WALL TR1M
GENERAL ARRANGEMENT

Drawn	Engineer	Checked	Approved
DB	DJ	NB	NS
Date	Date	Date	Date
AUG/13	AUG/13	AUG/13	SEP/13
Scale	Scale	Scale	Scale
A1	AS SHOWN		
SCG No.	Filename		
SC6NO			

Drawing No. 1007/30/DF7/A6-MA/TR1M/011 Revision A